



### Model Number

**NBB5-18GM60-WS-V12**

### Features

- 5 mm flush
- 2-wire AC

### Accessories

#### BF 18

Mounting flange, 18 mm

#### EXG-18

Quick mounting bracket with dead stop

## Technical Data

### General specifications

Switching element function		AC	NO
Rated operating distance	$s_n$	5 mm	
Installation		flush	
Output polarity		AC	
Assured operating distance	$s_a$	0 ... 4.05 mm	
Reduction factor $r_{Al}$		0.2	
Reduction factor $r_{Cu}$		0.2	
Reduction factor $r_{304}$		0.6	

### Nominal ratings

Operating voltage	$U_B$	20 ... 253 V
Switching frequency	$f$	0 ... 20 Hz
Hysteresis	$H$	typ. 6 %
Reverse polarity protection		reverse polarity tolerant
Voltage drop	$U_d$	< 5 V ( $I_L > 50$ mA); < 8 V ( $I_L < 50$ mA)
Momentary current (20 ms, 0.1 Hz)		0 ... 1600 mA
Operating current	$I_L$	5 ... 200 mA
Off-state current	$I_r$	0 ... 1.7 mA typ.
Time delay before availability	$t_v$	≤ 30 ms
Operating voltage indicator		LED, green
Switching state indicator		LED, yellow

### Ambient conditions

Ambient temperature	-25 ... 70 °C (-13 ... 158 °F)
---------------------	--------------------------------

### Mechanical specifications

Connection type	Connector 1/2"-20 UN , 3-pin
Housing material	brass, nickel-plated
Sensing face	PBT
Degree of protection	IP67
Note	<sup>1)</sup> In the temperature range below 0 °C, permissible operating voltage $U_b$ 80...253 V Safety fuse ≤ 0.8 A (quick-blow) according to IEC 60127-2 Sheet 1 Recommendation: after a short circuit, check that the device is functioning correctly.

### Compliance with standards and directives

Standard conformity	
Standards	EN 60947-5-2:2007 IEC 60947-5-2:2007

### Approvals and certificates

UL approval	cULus Listed, General Purpose
CSA approval	cCSAus Listed, General Purpose
CCC approval	Certified by China Compulsory Certification (CCC)

## Dimensions

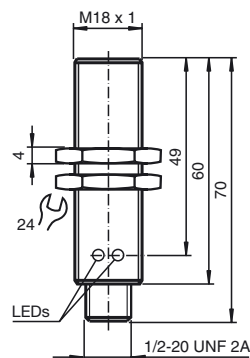

## Electrical Connection

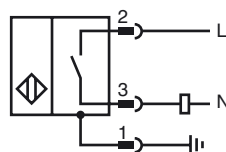

Pinout

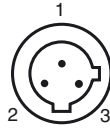

Wire colors

1	GN	(green)
2	RD/BK	(red/black)
3	RD/WH	(red/white)